

FORM NO 1.

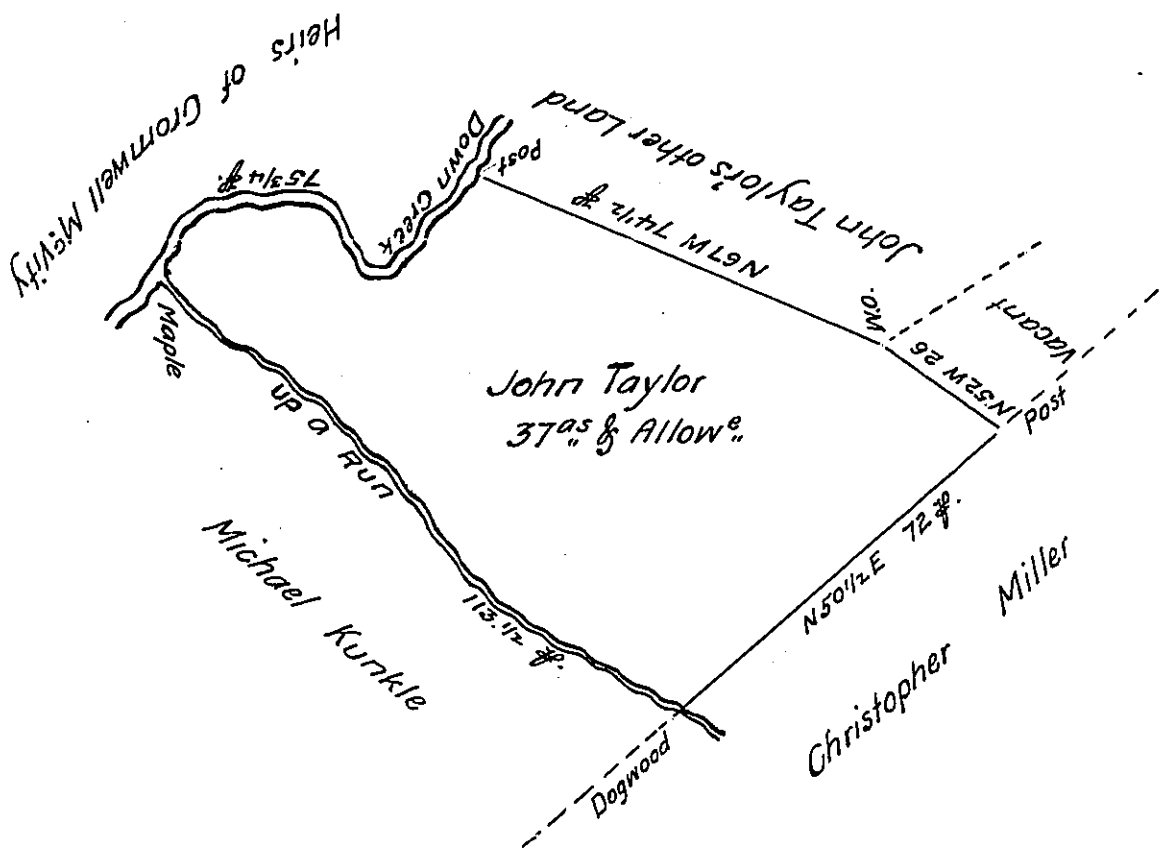

Courses & Distances on Creek
Beg. at Post thence down D^o.

S 41° W 26'13 ³/₄.
 N 54 W. 6 ³/₄
 North ----- 6
 N 70 W 13
 S 75 W 15
 S 16 W - 8 ³/₄ to Maple
 75 ³/₄

thence up run

S 51 E 48'12 ³/₄.
 S 38 E 35
 S 60 E 30 to Dogwood
 113'12

The above describes a piece of Land situate in Ambersons Valley in the County of Franklin, Containing thirty seven Acres, & the Allowance of six ³/₄ Cent & c. Survey'd, 28th April 1802. in pursuance of a Warrant granted to John Taylor bearing Date 23^d October 1801.

To Samuel Cochran Esquire }
 Surveyor General.

Dan^l. Henderson D.S.

IN TESTIMONY that the above is a copy of the original remaining on file in the Department of Internal Affairs of Pennsylvania, made conformably to an Act of Assembly approved the 16th day of February, 1833, I have hereunto set my Hand and caused the Seal of said Department to be affixed at Harrisburg, this twentieth day of March 1908

Henry Howell
 Secretary of Internal Affairs.